

CORRECTED PLAT  
OF  
**COLLEGE ANNEX**  
TO  
GRAND VIEW ADDITION  
McPHERSON KANSAS

SCALE 100 FT TO 1 INCH

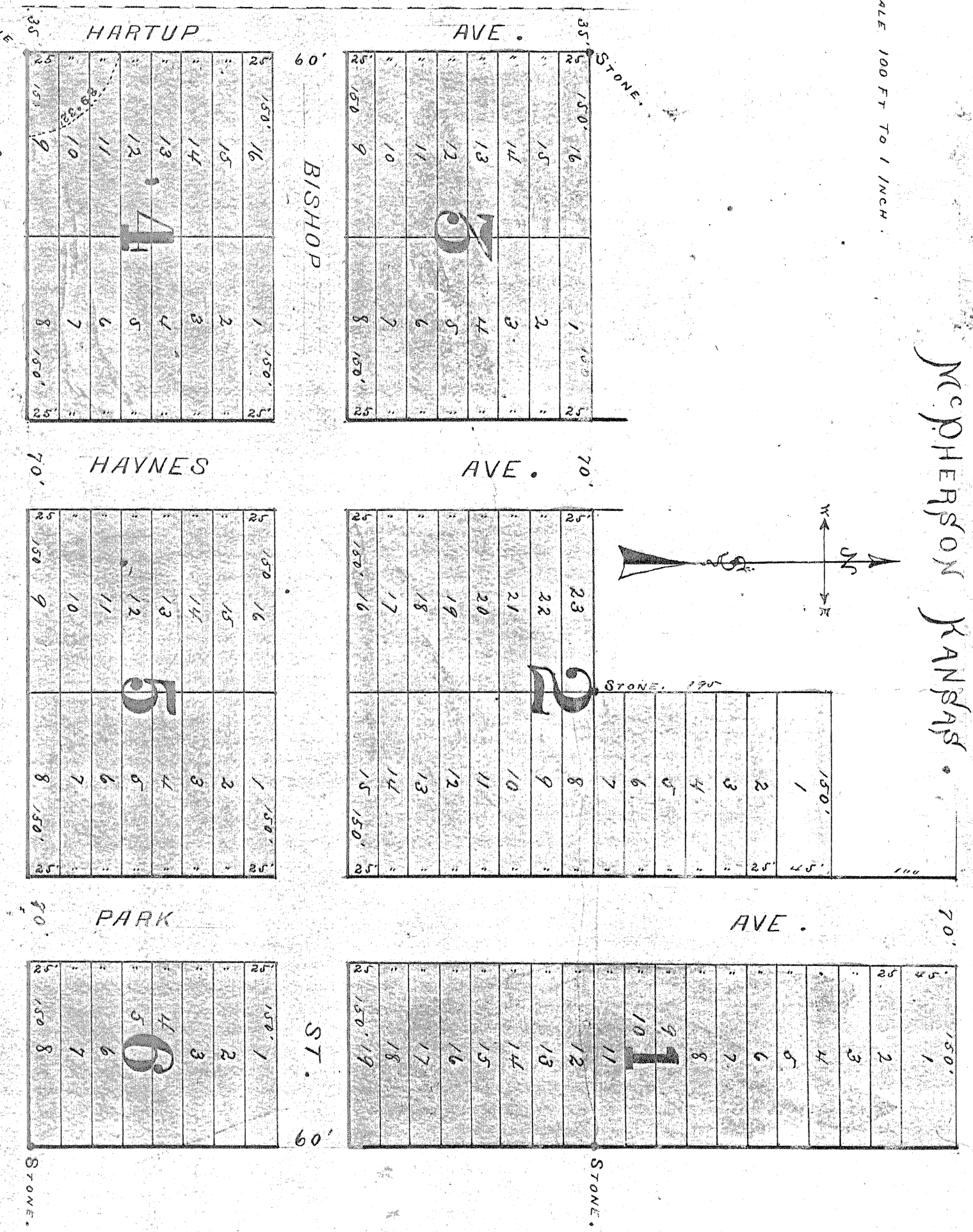

State of Kansas, }  
County of McPherson } S.S. A true copy of original as filed for  
Record on the 4<sup>th</sup> day of June A.D. 1888.  
at 9 o'clock  
Alex. S. Roth, Ray Davis

By Special Act - Chapter 168, Session Laws 1893 - The Streets, alleys, Lots and Blocks of that part of College Annex to Grand View Addition which is located upon the S.W. 1/4 of the S.E. 1/4 of Sec. 25, Twp. 19 S., of R. 3 N. 6 E. M. and hereby vacated."

College Annex to Grand View Addition to the City of McPherson Kansas is situated in the West 1/2 of the S.E. 1/4 of Sec 25, T19 R32 of the 6<sup>th</sup> P.M. and is more fully described as follows to wit: Beginning at a stone at the S.W. corner of 13<sup>th</sup> St. in Grand View Addition to the City of McPherson Kansas, thence running South along the east side of Hartup Avenue and parallel with the 1<sup>st</sup> section line four hundred and thirty (330) feet to a stone. Thence East eight hundred and thirty (830) feet to a stone. Thence North seven hundred and fifty five (755) feet. Thence North West One hundred and twenty (120) feet, to the S.E. corner of Block five (5) in Grand View Addition to McPherson Kansas, thence South One hundred (100) feet to the South East corner of lot four (4) in the above said Block five in Grand View Addition to the City of McPherson Kansas. Thence West One hundred and fifty feet to the S.W. corner of the above said Block five in above said Grand View Addition. thence North West One hundred and thirty (130) feet to a stone at the S.E. corner of lot five in above said Block five in above said Grand View Addition to the City of McPherson Kansas, thence West along the south side of the West 1/2 of Block five and the south side of Block six in Grand View Addition to the City of McPherson Kansas. Five hundred and twenty (520) feet to place of beginning Hartup Avenue as indicated by the East in that portion in Dinkens Addition to the City of McPherson Kansas, lying East of the 1<sup>st</sup> section line.

This Plat is filed to correct error in the Plat of College Annex to Grand View Addition to the City of McPherson Kansas, as filed on the 30<sup>th</sup> day of August A.D. 1887. I do hereby certify that the above Plat and notes are correct and conform strictly to a survey made by me on the 21<sup>st</sup> day of May A.D. 1888.

J. P. Cole, C. E.

Know all men by these presents that the Grand View Investment Company Incorporated under the laws of the State of Kansas, in the presence of the land upon which said College Annex to Grand View Addition to the City of McPherson Kansas is situated as shown by the above Plat, and in Class Wheeler, Recorder and A. Row Secretary do hereby certify that we are the Officers of said company, and that the disposition of this plat is in accordance with our design and intention. The streets and alleys shown by the above Plat are hereby dedicated to and for the use of the Public. Witness our hands this 1<sup>st</sup> day of June 1888.

Attest A. Row, Secretary.      Signed Class Wheeler, President.



State of Kansas, }  
County of McPherson, } S.S.

Attest A. Row, Secretary.      Signed Class Wheeler, President.

13. It is remembered on this 1<sup>st</sup> day of June A.D. 1888. before me a Notary Public, in and for the State and County aforesaid, personally appeared Class Wheeler and A. Row who are known to me to be the same persons who executed the foregoing instrument of writing, and such persons duly acknowledged the same.

In witness whereof I have hereunto set my hand and official seal and the date of the above writing on this day and year last above written 1888. My Notary Public.

My Commission Expires July 9 1891

